

# Luxe Duo

## INSTRUCTIONS

### LAMPING

Risk of fire and electrical shock. Installation requires knowledge of electrical systems and should be installed by a qualified electrician. If not qualified, DO NOT ATTEMPT INSTALLATION.

To avoid the risk of fire or overheating, do not exceed the recommended wattage.

SHUT OFF ELECTRICAL SUPPLY AT THE CIRCUIT BREAKER

This fixture can be mounted VERTICALLY or HORIZONTALLY

**\*\*WHEN INSTALLING THIS FIXTURE IN A HORIZONTAL ORIENTATION, THE JBOX MUST ALSO BE INSTALLED IN A HORIZONTAL\*\***

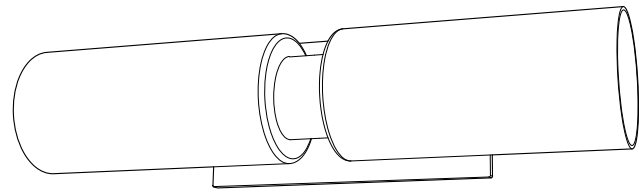

### CARE INSTRUCTIONS

Wipe with a soft cloth only. Always avoid using harsh chemicals and/or cleaners.

fig. A

### LAMPING

Place the mounting bracket against the junction box while allowing wires to pass through the central opening. Fasten mounting plate/bar to junction box with the mounting screws [2] provided.

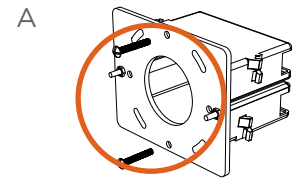

fig. B

### WIRE CONNECTION

Attach the junction box GROUND WIRE to the bare copper GROUND WIRE from the fixture. Fasten with a plastic wire nut. If there is not a ground wire from the junction box, wrap the bare copper ground wire from the fixture around the green screw on the mounting bracket.

Connect the fixture's WHITE [neutral] wire to the NEUTRAL WIRE from the junction box.

Connect the fixture's BLACK [hot] wire to the HOT WIRE from the junction box.

Tuck the wired connections into the junction box and position the fixture's backplate correctly over the mounting plate/bar. Wires must be neatly positioned for the fixture to sit properly on the mounting plate.

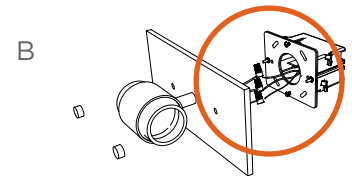

fig. C

Secure the fixture to the mounting plate with the decorative thumb screws [2].

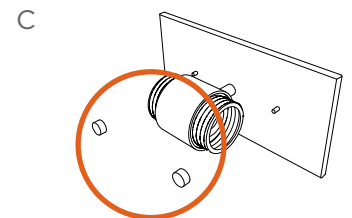
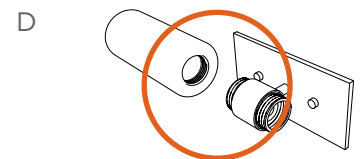

fig. D

Place each diffuser over the socket and screw it into place. Do not over tighten. Insert the lamps [2] [not included]



Restore power to the junction box.

# Luxe Duo

## INSTRUCTIONS

### LAMPING OPTIONS

This light fixture uses either incandescent or replaceable CFL [compact fluorescent lamp] lamps as a lighting source.

EPA recommends that consumers take advantage of available local recycling options for CFL light bulbs. Ayre recommends contacting your local municipal waste agency for more information, or visit [www.earth911.org](http://www.earth911.org) to identify local recycling efforts.

*"Most makers of light bulbs have reduced mercury in their fluorescent lighting products. Thanks to technology advances and commitment from members of the National Electrical Manufacturers Association, the average mercury content in CFLs has dropped at least 20 percent or more in the past several years. Some manufacturers have even made further reductions, dropping mercury content to 1 mg per light bulb." - energystar.gov*



Requires [2] 13W, 4-pin, 2700K or 3000K CFL's to fit the fixtures 2GX7 CFL socket.

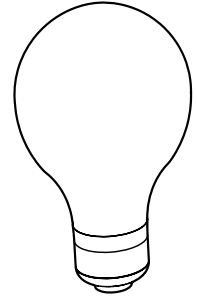

Requires [2] 100W lamps to fit the fixtures medium based incandescent socket.

### ELECTRICAL ROUGH-IN

A standard single rectangular junction box is required for installation.

The Luxe Duo can be mounting in a vertical or horizontal position. When installing in a bathroom AYRE has the following recommendations:

When marking the rough-in for the junction box(es), each fixture should have a total distance of 20-30" from center to center depending on the cabinet or mirror installed.

**\*\*WHEN INSTALLING THIS FIXTURE IN A HORIZONTAL ORIENTATION, THE JBOX MUST ALSO BE INSTALLED HORIZONTALLY\*\***

